

**book  
now!**

# **one brilliant meeting space**

**Voluntary, Community and Social Enterprise**



Newcastle upon Tyne  
NE1 4BX



# one perfect location



## Walking Times

St James Metro	3 mins
Monument Metro	7 mins
Central Station Metro	11 mins
Central Station	11 mins
Eldon Square	6 mins
St James Park	1 min
Northumberland Street	9 mins
Haymarket Bus & Metro Interchange	7 mins
Grey Street	8 mins
Newcastle Helix	6 mins
Hadrian's Tower	7 mins
Newcastle University Business School	3 mins







**From co-working and coffee catch ups,  
to team meetings and large events,  
we've got you covered**



# your space your choice



Nowhere else gives you the choice of spaces you'll get at One Strawberry Lane.  
We have a range of environments to support neurodiversity, accessibility and inclusivity.  
Whatever you are looking for, we can help.

- public  private 
- active  static 
- open  enclosed 
- large  small (single, group, department) 
- loud  quiet 
- bright  dim (adjustable) 
- bookable  ad-hoc 

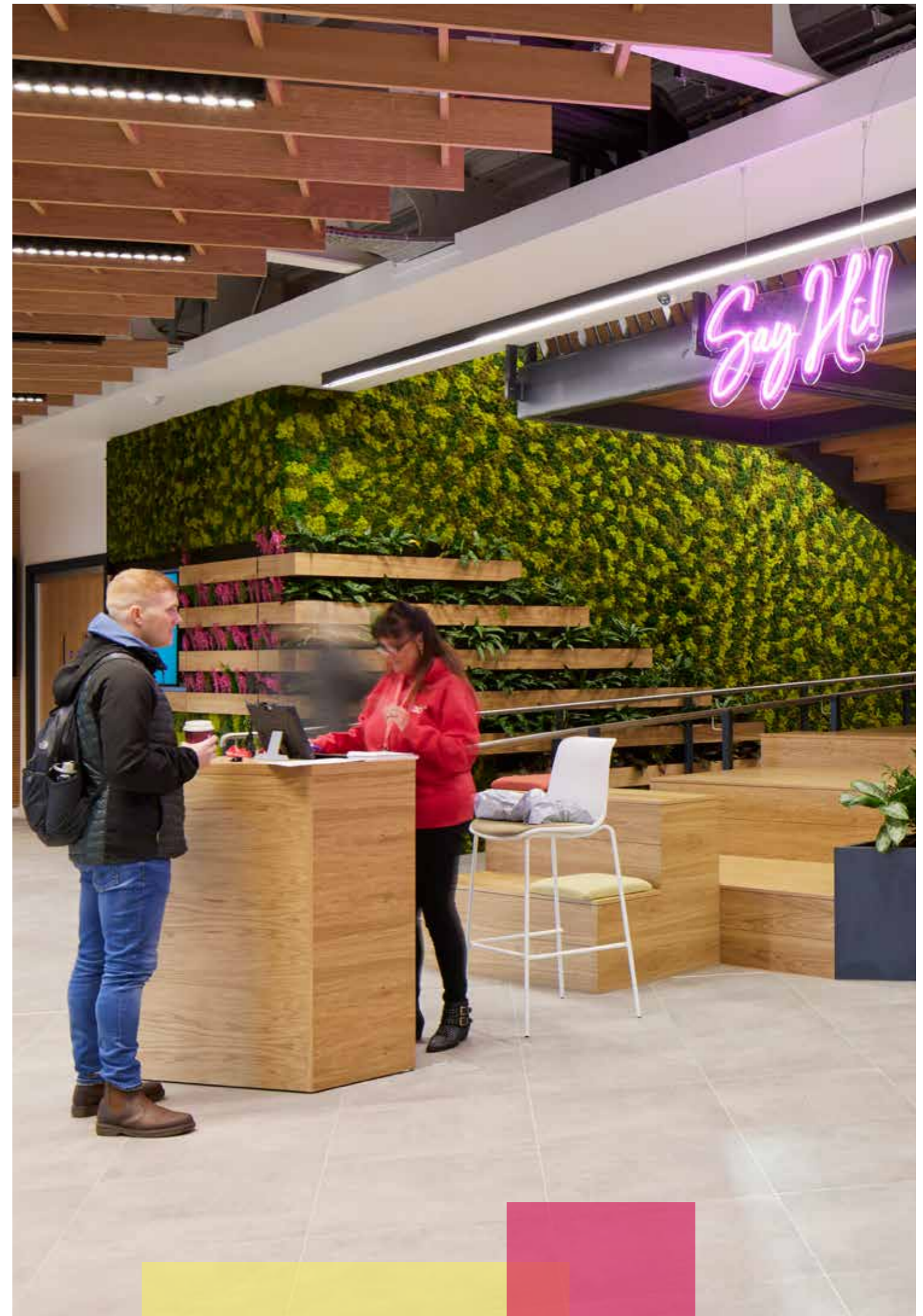

# book space at



There are a range of collaborative spaces at One Strawberry Lane to accommodate different types of meetings and events. There are meeting rooms for 2-24 people and some larger multi-function rooms that can accommodate larger groups in a range of layouts (the layout can be selected when booking the space) up to c.90 people.

Free space or 50% discount for voluntary and community sector bookings.

Get in touch to discuss catering options.

All prices are subject to VAT.



ground floor						
room	area	capacity	hourly rate	full day	half day	evening
Greenhouse multifunction (2A and 2B combined)	130m <sup>2</sup> 1401ft <sup>2</sup>	72-96	n/a	£800 £400	£420 £210	£400 £200
Greenhouse 2A or 2B	65m <sup>2</sup> 700ft <sup>2</sup>	36	n/a	£400 £200	£220 £110	£150 £75
Greenhouse 1	22m <sup>2</sup> 240ft <sup>2</sup>	9	£40 £20	£250 £125	£150 £75	n/a
Greenhouse 3	22m <sup>2</sup> 240ft <sup>2</sup>	9	£40 Free	£250 Free	£150 Free	n/a
Open plan area with stage*	400m <sup>2</sup> 4,305ft <sup>2</sup>	112				£600 £300
Innovation challenges hub*	50m <sup>2</sup> 532ft <sup>2</sup>	35	Free	Free	Free	£150 Free

\* Any evening booking for the open plan area also includes use of the innovation challenges hub.

first floor						
room	area	capacity	hourly rate	full day	half day	evening
Room 1	19m <sup>2</sup> 208ft <sup>2</sup>	8	£30 £15	£180 £90	£100 £50	n/a
Room 3	15m <sup>2</sup> 165ft <sup>2</sup>	4	£30 £15	£170 £85	£90 £45	n/a
Room 4	14m <sup>2</sup> 146ft <sup>2</sup>	6	£30 £15	£180 £90	£100 £50	n/a

second floor						
room	area	capacity	hourly rate	full day	half day	evening
Room 2	33m <sup>2</sup> 356ft <sup>2</sup>	18	n/a	£350 £175	£180 £90	n/a

Full day (8am - 6pm), half day (8am - 1pm or 1pm - 6pm), evening (5pm - 8pm)



# ground floor

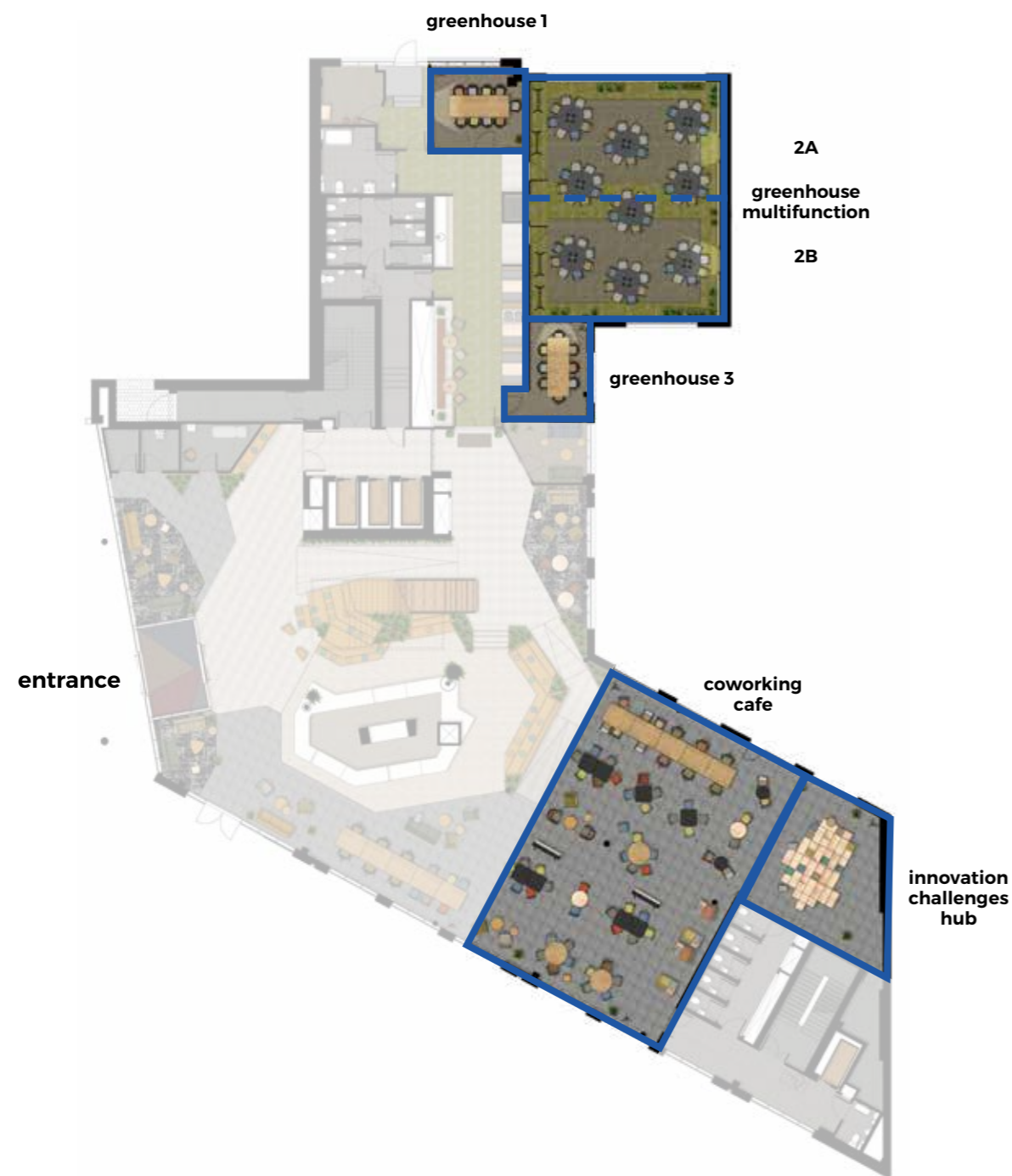

ground floor							
room	area	capacity	hourly rate	full day	half day	evening	av equipment
Greenhouse multifunction (2A and 2B combined)	130 m <sup>2</sup> 1401 ft <sup>2</sup>	72-96	n/a	£800 £400	£420 £210	£400 £200	2 x 98" Screen, Full AV incl speakers microphone, lectern
Greenhouse 2A or 2B	65 m <sup>2</sup> 700 ft <sup>2</sup>	36	n/a	£400 £200	£220 £110	£150 £75	98" Screen, Full AV incl speakers microphone, lectern
Greenhouse 1	22m <sup>2</sup> 240 ft <sup>2</sup>	9	£40 £20	£250 £125	£150 £75	n/a	65" screen plug and play
Greenhouse 3	22m <sup>2</sup> 240 ft <sup>2</sup>	9	£40 Free	£250 Free	£150 Free	n/a	65" screen plug and play
Open plan area with stage*	400 m <sup>2</sup> 4,305 ft <sup>2</sup>	112				£600 £300	98" Screen, Full AV incl speakers microphone, lectern and stage
Innovation challenges hub*	50 m <sup>2</sup> 532 ft <sup>2</sup>	35*	Free	Free	Free	£150 Free	65" screen plug and play

\* Any evening booking for the open plan area also includes use of the innovation challenges hub.









## Greenhouse multi-function room

### How can I use this space?

The multi-function suite has flexible furniture so that the space can be booked with a choice of 12 different layouts to suit the type of activity you'd like to undertake. The room itself can be split into two rooms to accommodate two smaller meetings or used as one large space. Due to this flexibility, it can be booked to accommodate anything from small meetings of 14 people up to cinema style conferences of 90 people!

floor	sq m	sq ft	capacity	hourly rate	full day	half day	evening	av equipment
ground	130	1401	72-96	n/a	£800 £400	£420 £210	£400 £200	2 x 98" Screen, Full AV incl speakers microphone, lectern

-  private
-  static
-  enclosed
-  large
-  quiet
-  bright
-  bookable







Boardroom 1

<b>capacity</b>	18
<b>stage</b>	no



Boardroom 2

<b>capacity</b>	44
<b>stage</b>	no



Boardroom 3

<b>capacity</b>	28
<b>stage</b>	no



Theatre style

<b>capacity</b>	96
<b>stage</b>	yes

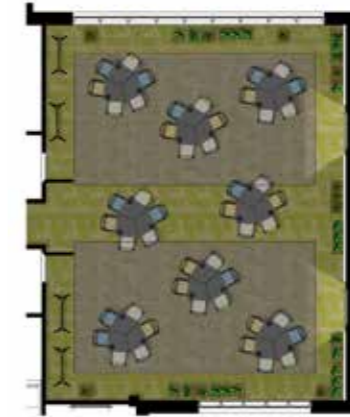

Conference cluster 1

<b>capacity</b>	48
<b>stage</b>	no

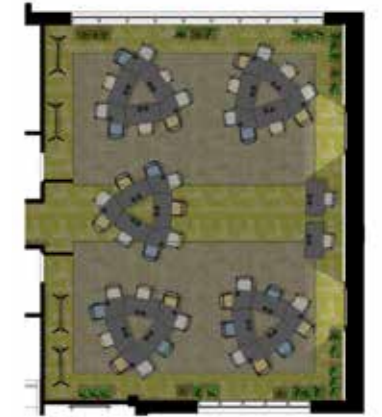

Conference cluster 2

<b>capacity</b>	45
<b>stage</b>	no



Boardroom 4 (split)

<b>capacity</b>	24 + 24
<b>stage</b>	no



Boardroom 5

<b>capacity</b>	20
<b>stage</b>	no



Training

<b>capacity</b>	72
<b>stage</b>	no

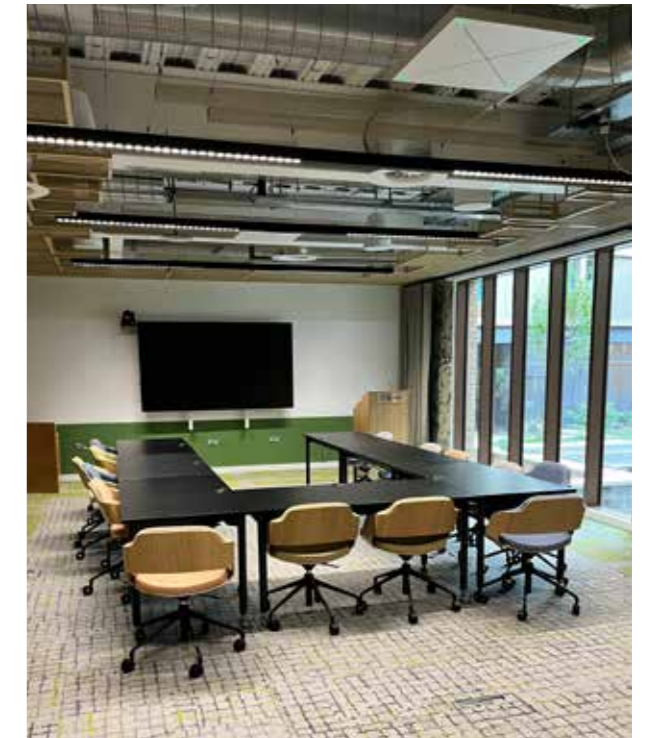





## Greenhouse 1



floor	sq m	sq ft	capacity	hourly rate	full day	half day	evening	av equipment
ground	22	240	9	£40 £20	£250 £125	£150 £75	n/a	65" screen plug and play

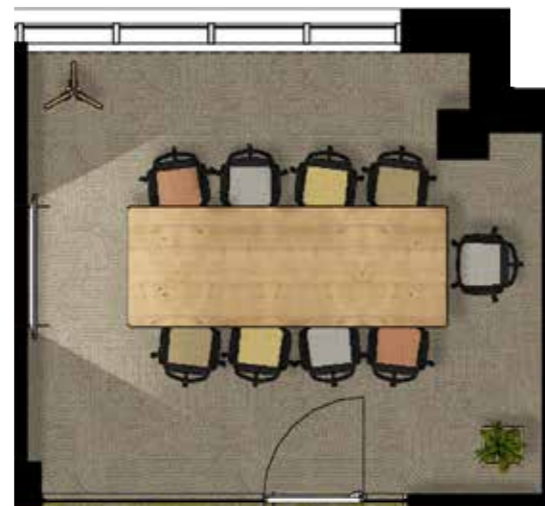

-  private
-  static
-  enclosed
-  small
-  quiet
-  bright
-  bookable



## Greenhouse 3



floor	sq m	sq ft	capacity	hourly rate	full day	half day	evening	av equipment
ground	22	240	9	£40 Free	£250 Free	£150 Free	n/a	65" screen plug and play

-  private
-  static
-  enclosed
-  small
-  quiet
-  bright
-  bookable

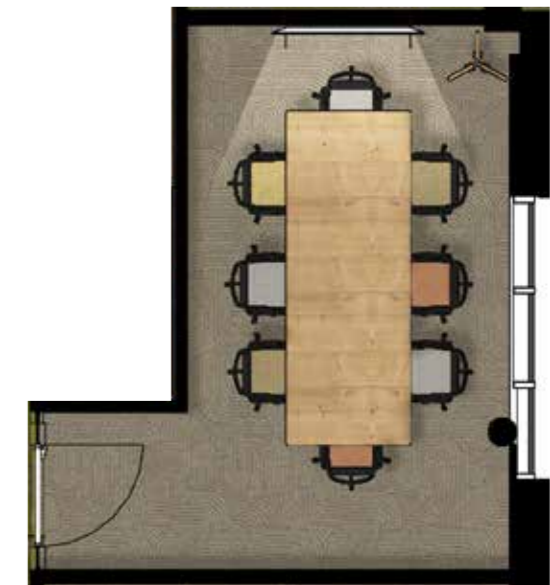







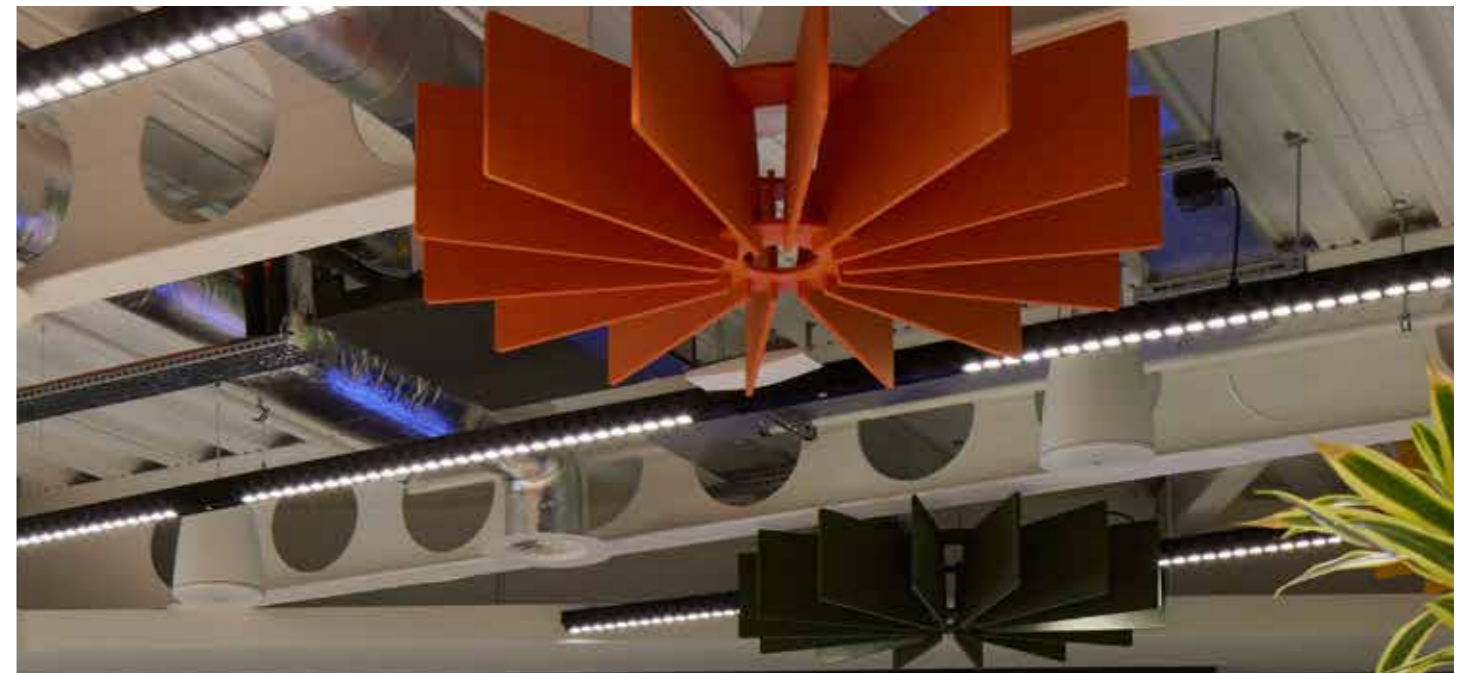

# Innovation challenges hub

## How can I use this space?

The innovation challenges hub is where you can go to help the voluntary community sector organisations find solutions to their current challenges. Just drop in if you're passing. This is a great space for workshops or informal meetings, with flexible furniture and writable walls - you can set it up just how you want it!

floor	sq m	sq ft	capacity	hourly rate	full day	half day	evening	av equipment
ground	50	532	35	Free	Free	Free	£150 Free	65" screen plug and play



-  public
-  active
-  open
-  large
-  loud
-  bright
-  bookable





Coworking cafe



-  public
-  active
-  open
-  large
-  loud
-  bright
-  bookable
-  ad-hoc

Coworking cafe

floor	sq m	sq ft	capacity	hourly rate	full day	half day	evening	av equipment
ground	400	4,305	90-112				£600 £300	98" Screen, Full AV incl speakers microphone, lectern and stage



# first floor

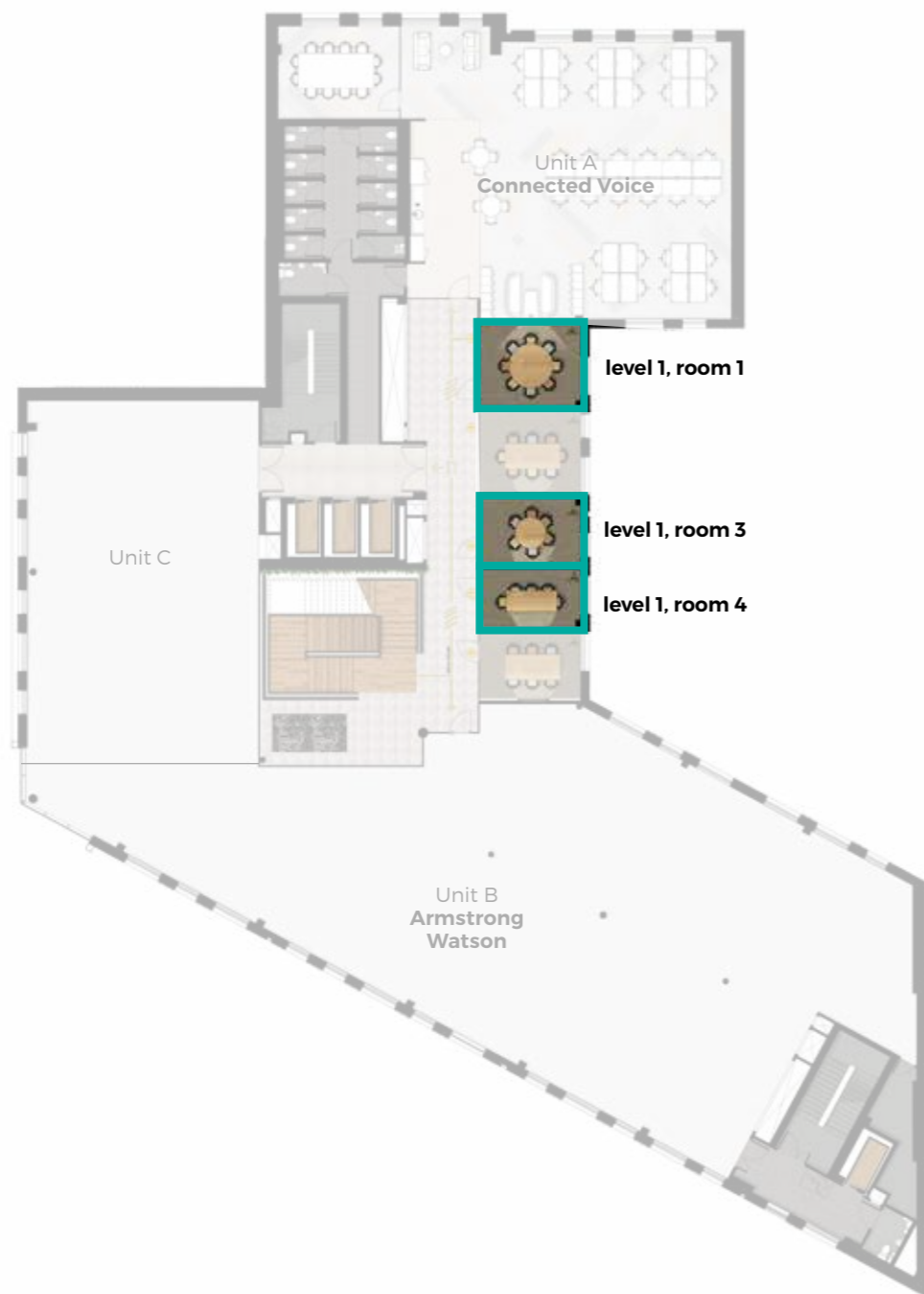

first floor							
room	area	capacity	hourly rate	full day	half day	evening	av equipment
Room 1	19 m <sup>2</sup> 208 ft <sup>2</sup>	8	£30 £15	£180 £90	£100 £50	n/a	65" screen plug and play
Room 3	15 m <sup>2</sup> 165 ft <sup>2</sup>	5	£30 £15	£170 £85	£90 £45	n/a	65" screen plug and play
Room 4	14 m <sup>2</sup> 146 ft <sup>2</sup>	6	£30 £15	£180 £90	£100 £50	n/a	65" screen plug and play



First floor, room 1

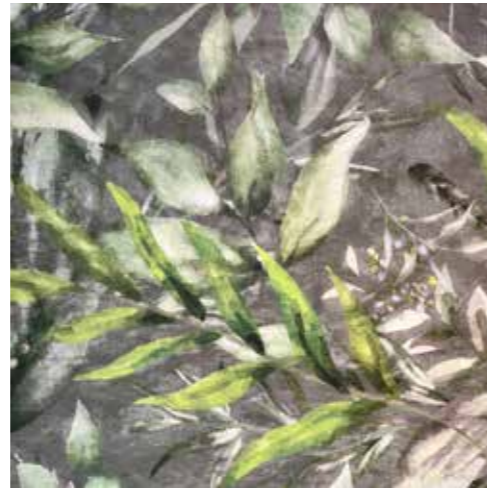

First floor, room 3

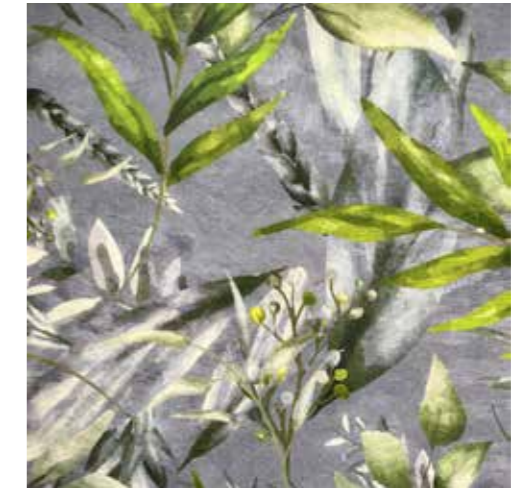



floor	sq m	sq ft	capacity	hourly rate	full day	half day	evening	av equipment
first	19	209	8	£30 £50	£180 £90	£100 £50	n/a	65" screen plug and play

floor	sq m	sq ft	capacity	hourly rate	full day	half day	evening	av equipment
first	15	165	4	£30 £15	£170 £85	£90 £45	n/a	65" screen plug and play

-  private
-  static
-  enclosed
-  small
-  quiet
-  bright
-  bookable



-  private
-  static
-  enclosed
-  small
-  quiet
-  bright
-  bookable





First floor, room 4

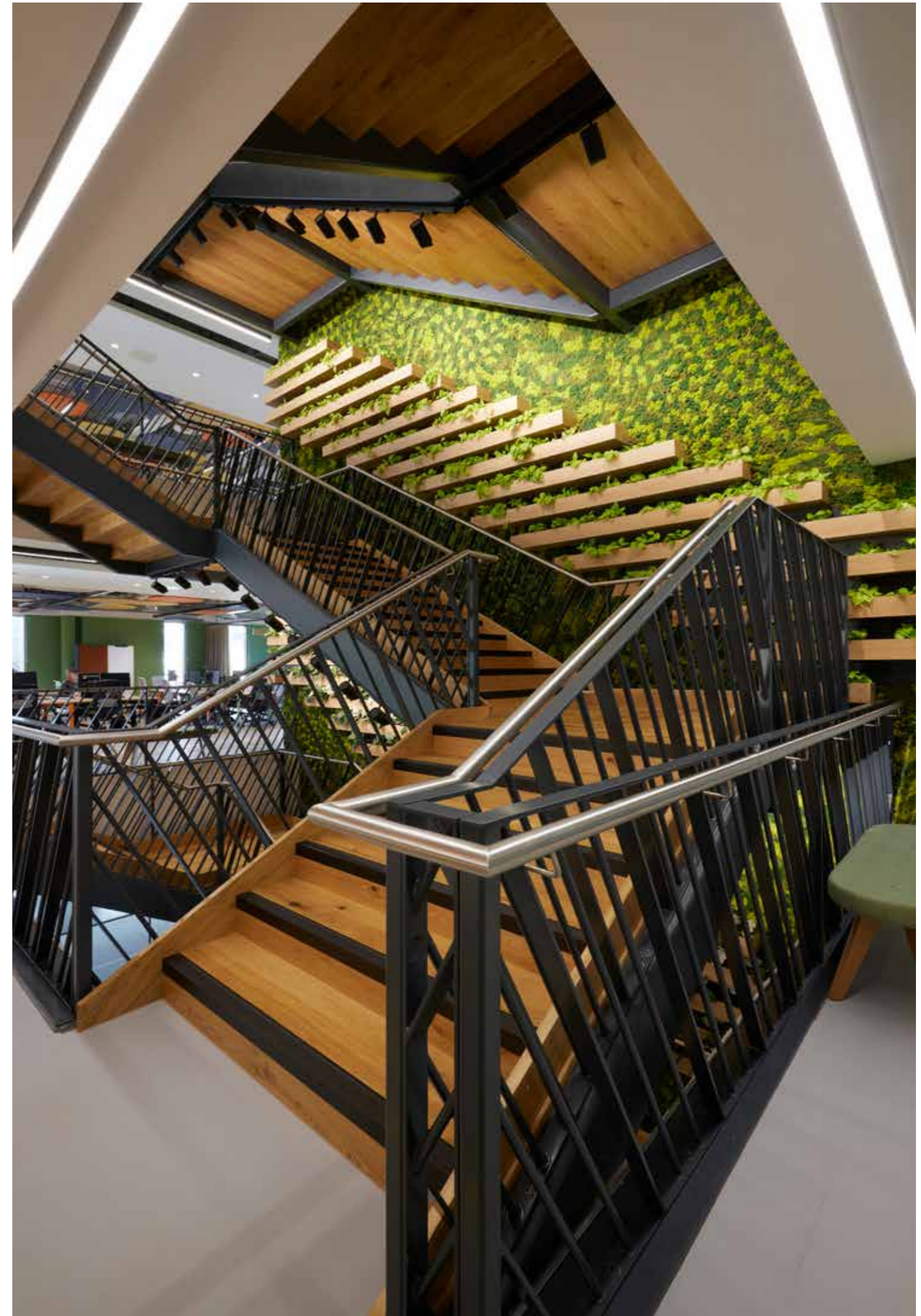

floor	sq m	sq ft	capacity	hourly rate	full day	half day	evening	av equipment
first	14	146	8	£30 £15	£180 £90	£100 £50	N/A	65" screen plug and play

-  private
-  static
-  enclosed
-  small
-  quiet
-  bright
-  bookable

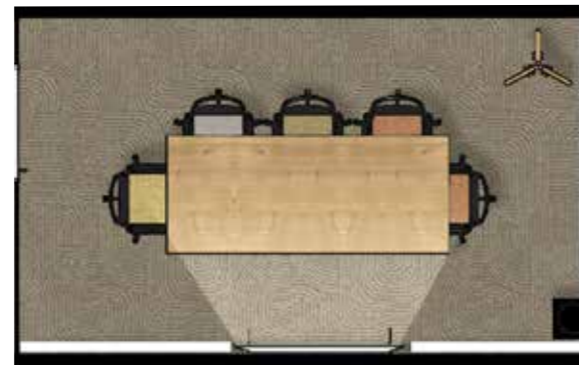

×	×	×	×	×	×	×	×	×
×	×	×	×	×	×	×	×	×
×	×	×	×	×	×	×	×	×
×	×	×	×	×	×	×	×	×
×	×	×	×	×	×	×	×	×



# second floor

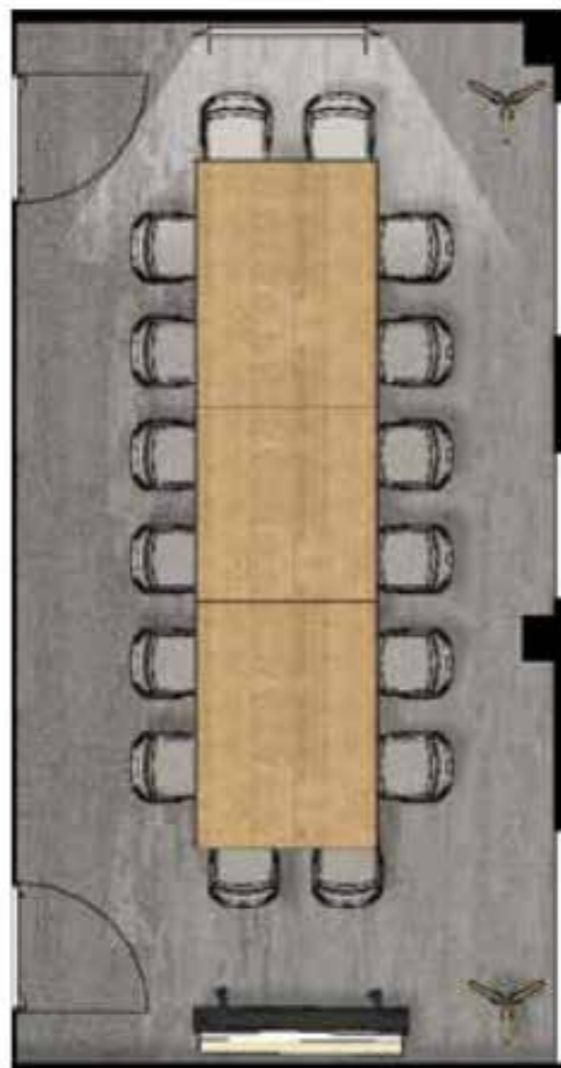

second floor								
floor	sq m	sq ft	capacity	hourly rate	full day	half day	evening	av equipment
second	33	356	18	n/a	£350 £175	£180 £90	n/a	82" screen plug and play



# Catering at One Strawberry Lane



## Breakfast

Classic – mini bacon, sausage, and veggie sausage sandwiches plus mini pastries  
£6.00 pp

Continental – mini breakfast sandwiches, mini pastries, fruit platter, granola pots with overnight oats and fresh juice, coffee  
£9.50 pp

## Lunch

Mini sandwiches, quiche, bruschetta  
£6.50 pp

Teriyaki chicken, caprese salad and veg and olive skewers  
£7.00 pp

Chicken or chickpea Thai green curry served with rice, mini naans and a selection of Indian nibbles  
£8.50 pp

Bruschetta and mixed meat platters, any one salad and one pasta from menu  
£9.00 pp

## Add-ons

Fruit platter  
£3.00 pp

Sweet treat platter  
£3.00 pp

Chocolate dipped strawberries  
£2.50 pp

## Drinks

Watermelon/strawberry iced tea  
£20 per large Kilner jar

A range of soft drinks and alcoholic beverages are also available

\*All prices per head + 10% service charge.

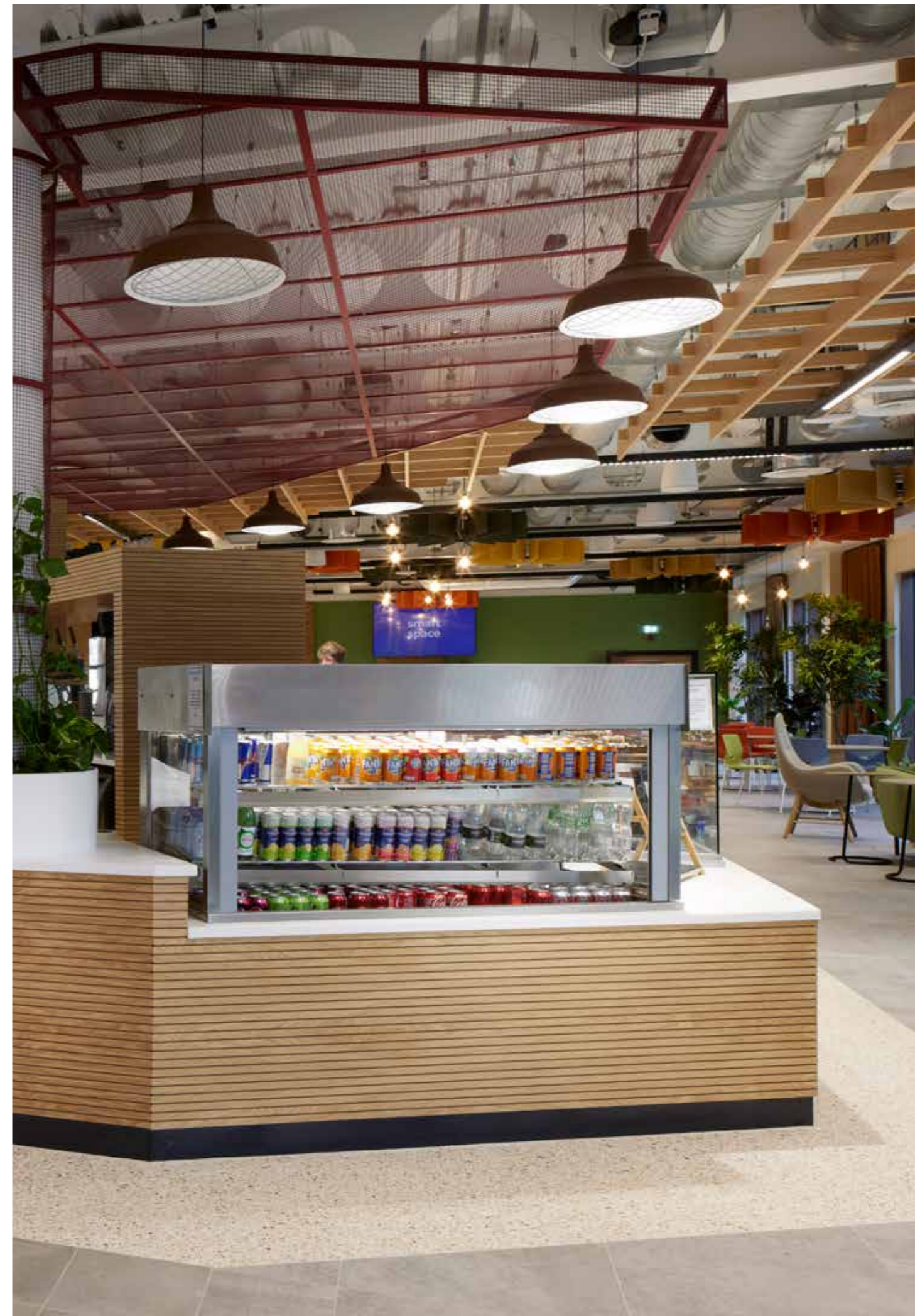



# book now!



Email us: [roombookings@onestrawberrylane.co.uk](mailto:roombookings@onestrawberrylane.co.uk)

We can't wait to see how we can make  
the freshest workspace in town work for you.



## One brilliant team...



**Nathalie Baxter**  
Head of workspace



**Alex Tams**  
Facilities and  
workspace manager



**Karen Haq**  
Workspace  
Community Manager



**Radiah Islam**  
Community host



**Ruth Jamwa**  
Community host



**Dylan Smith**  
Facilities  
coordinator



**Victoria Bone**  
Community host





one  
strawberry  
lane